

PHASE I

TRAFFIC LEGEND	
	WORK ZONE
	PROPOSED TRENCH
	CHANNELIZING DEVICE (CONE)
	SIGN
	FLAGGER
	SINGLE PARKING METER
	DOUBLE PARKING METER
	VARIABLE MESSAGE BOARD
	ARROW BOARD
	TYPE 3 BARRICADE
	HIGH LEVEL WARNING DEVICE
	CONSTRUCTION TRUCK
	TRUCK MOUNTED ATTENUATOR
	TRAFFIC FLOW
	TRAFFIC FLOW
	2 WAY TRAFFIC
	BARRIER
	UTILITY POLE
	UTILITY MANHOLE

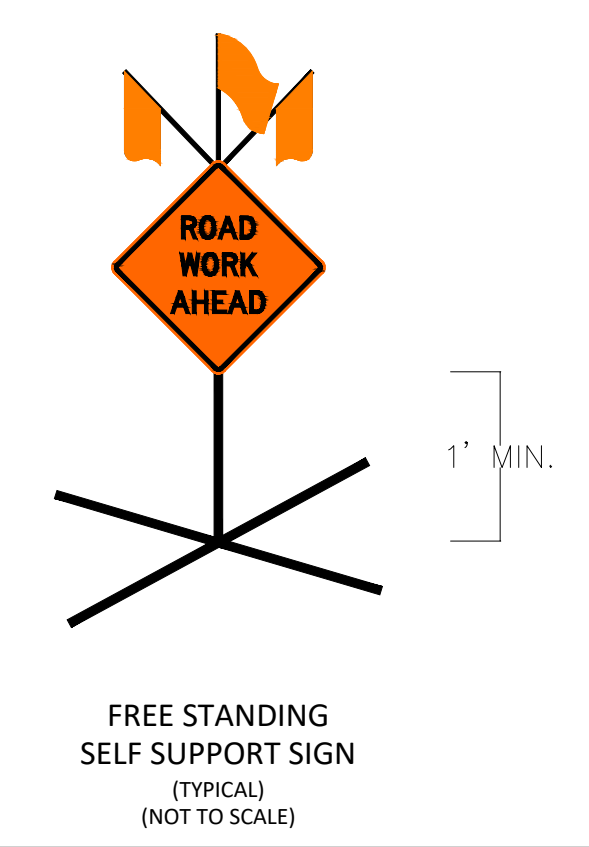
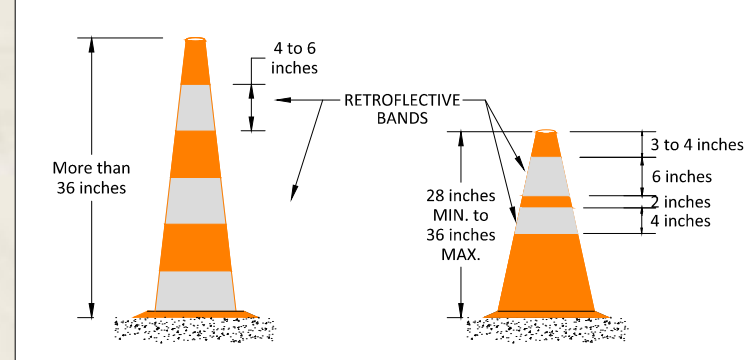
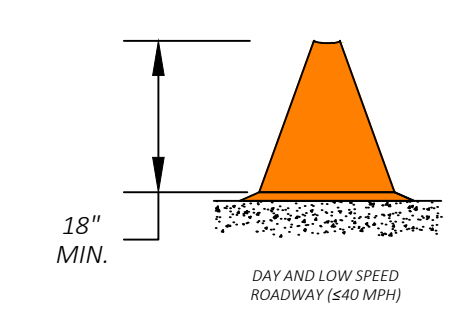

REV #	DESCRIPTION	DATE

NOTE:
EXISTING UTILITIES SHOWN ARE APPROXIMATE AND NOT WARRANTED TO BE CORRECT. THE CONTRACTOR SHALL VERIFY THE LOCATION OF ALL PUBLIC AND PRIVATE UTILITIES PRIOR TO BEGINNING ANY EXCAVATION.

KNOW WHAT'S BELOW CALL BEFORE YOU DIG IT'S FREE AND IT'S THE LAW
CALL 811 OR 1-800-272-1000

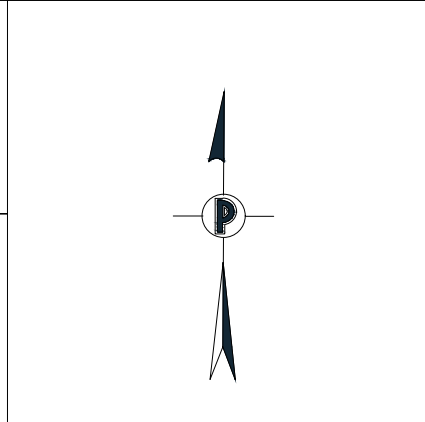
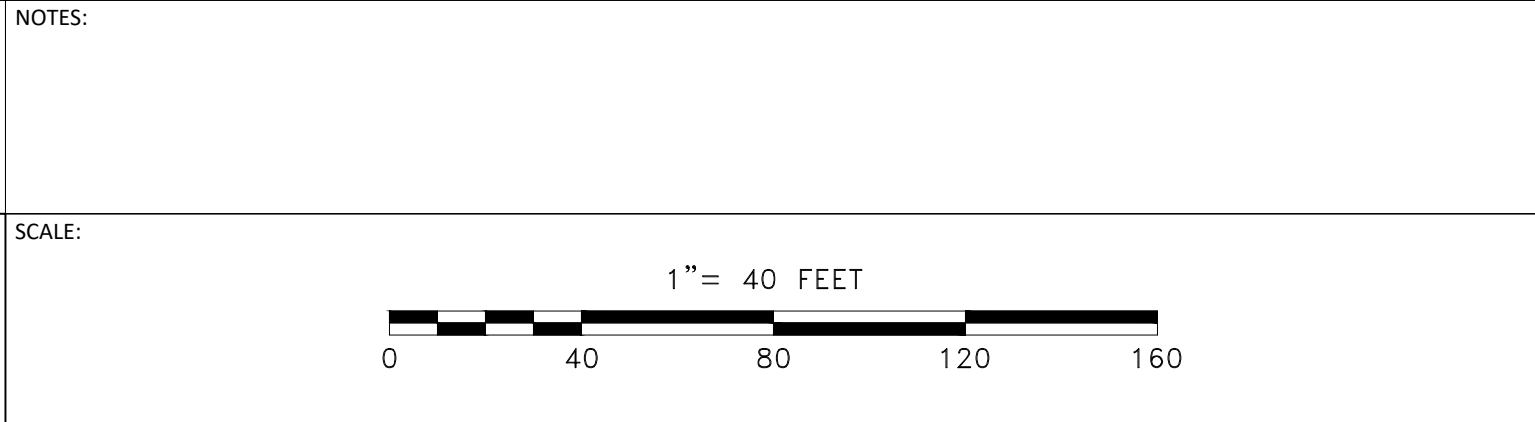

NOTE:
CONTRACTOR TO PLACE SIGNS AND TRAFFIC CHANNELIZATION DEVICES PER THE MUTCD.

NOTE:
ERIAL RD (CR-706)
URBAN MAJOR COLLECTOR
25 MPH

PREPARED BY:
PIKE TELECOM
21 Oxford Rd
Mansfield, MA 02048
www.piketecom.com
1-508-337-7600

PREPARED FOR:
verizon

TITLE:	
TRAFFIC MANAGEMENT PLAN - PHASE I ERIAL RD (CR-706) SICKLERVILLE, NJ	
SURVEYED BY: PIKE TELECOM	PRINT NO: 1 OF 6
DRAWN BY: JB	SCALE: 1" = 40'
DATE: 04/24/24	EWO: 4POGK9U WPI 2596187

04/24/2024 IN:G:\DIV\PERIZON\BAU\TMP\2024\44-TMP\W\4P\G\G\U\WPI\2596187-ERIAL RD (CR-706) CAMDEN COUNTY - TMP.dwg

PHASE II

TRAFFIC LEGEND	
	WORK ZONE
	PROPOSED TRENCH
	CHANNELIZING DEVICE (CONE)
	SIGN
	FLAGGER
	SINGLE PARKING METER
	DOUBLE PARKING METER
	VARIABLE MESSAGE BOARD
	ARROW BOARD
	TYPE 3 BARRICADE
	HIGH LEVEL WARNING DEVICE
	CONSTRUCTION TRUCK
	TRUCK MOUNTED ATTENUATOR
	TRAFFIC FLOW
	TRAFFIC FLOW
	2 WAY TRAFFIC
	BARRIER
	UTILITY POLE
	UTILITY MANHOLE

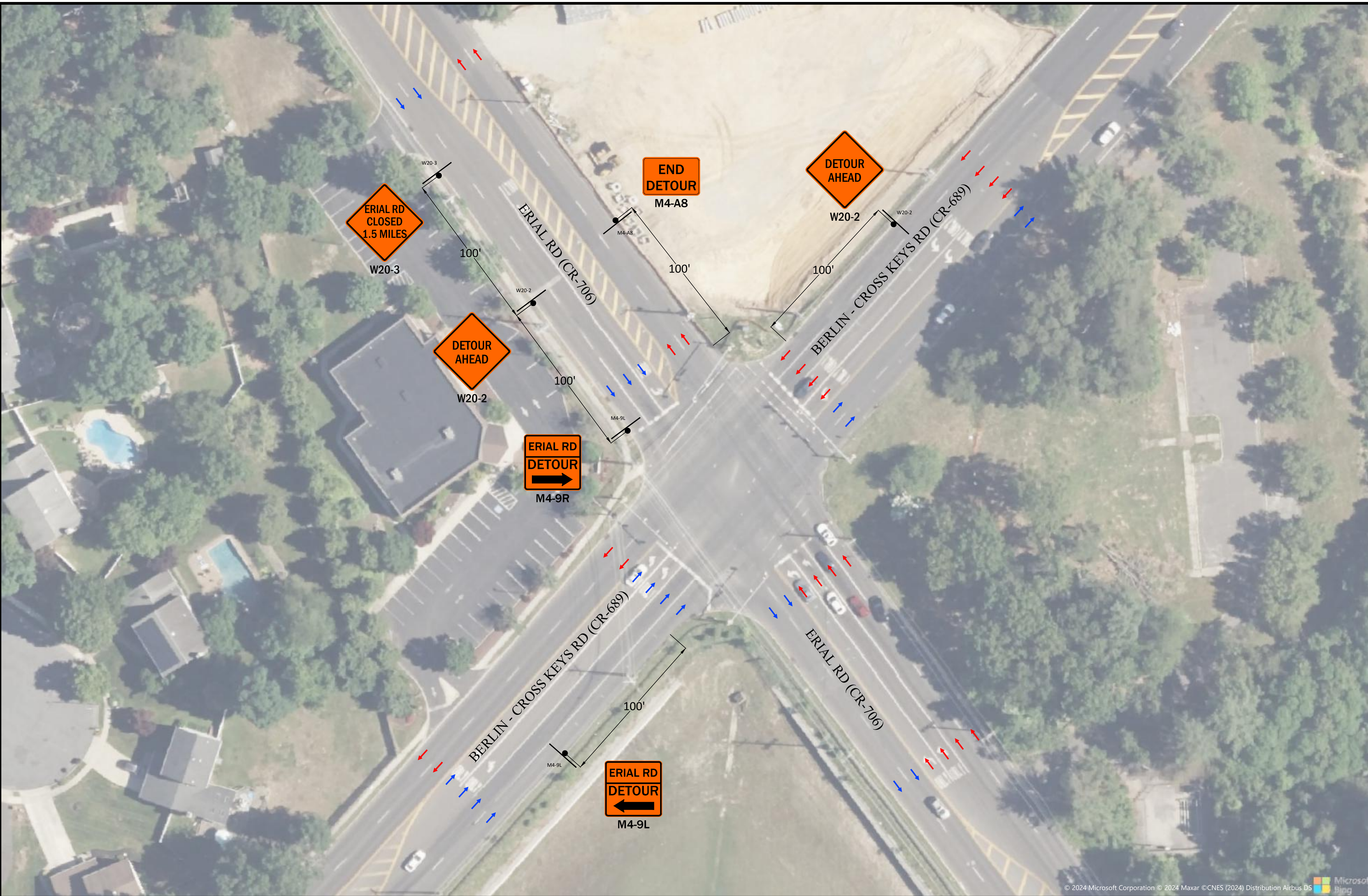
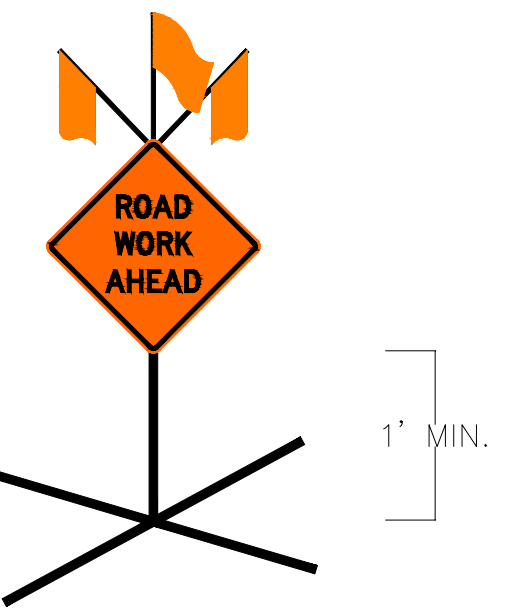
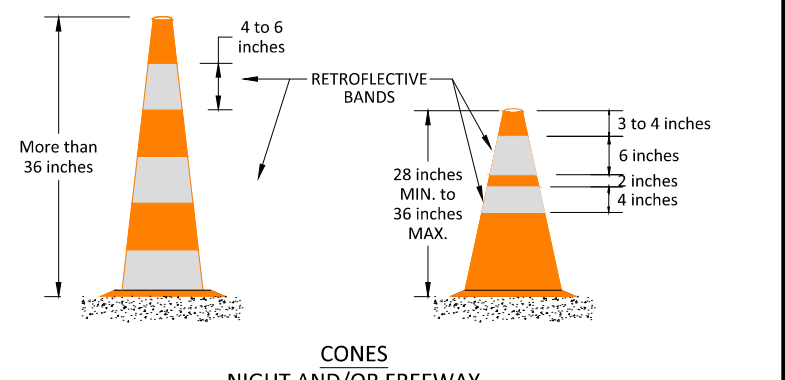
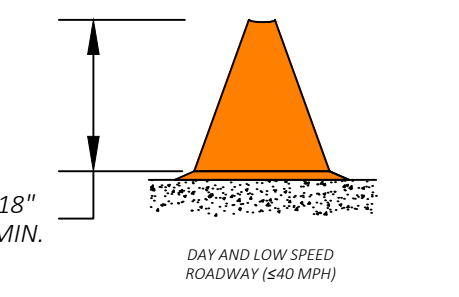

REV #	DESCRIPTION	DATE

NOTE:
EXISTING UTILITIES SHOWN ARE APPROXIMATE AND NOT WARRANTED TO BE CORRECT. THE CONTRACTOR SHALL VERIFY THE LOCATION OF ALL PUBLIC AND PRIVATE UTILITIES PRIOR TO BEGINNING ANY EXCAVATION.

ONE CALL
KNOW WHAT'S BELOW
CALL BEFORE YOU DIG
IT'S FREE AND IT'S THE LAW
CALL 811 OR 1-800-272-1000

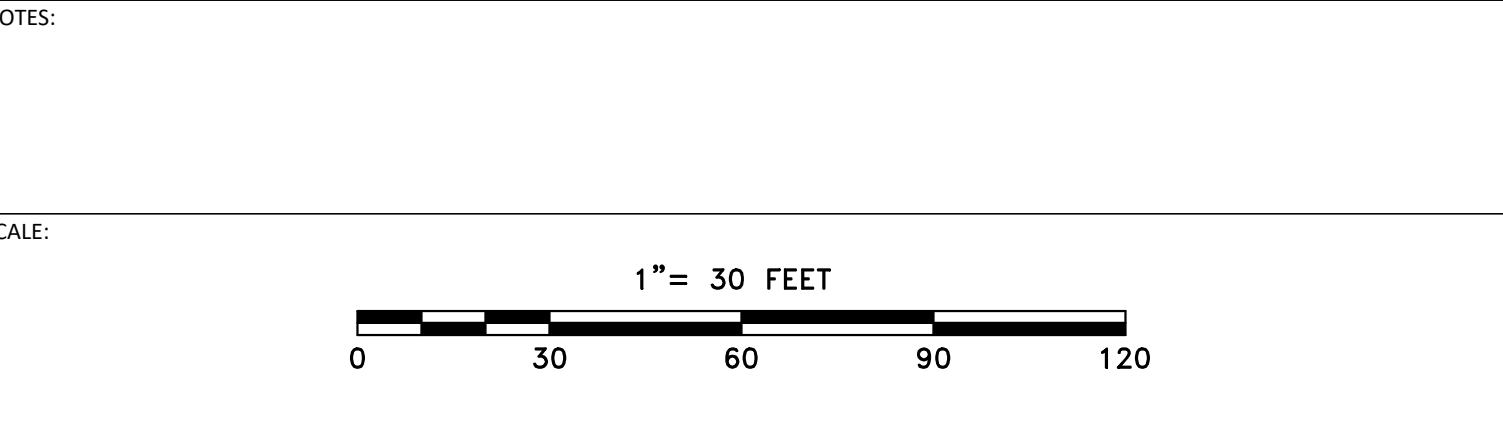

NOTE:
CONTRACTOR TO PLACE SIGNS AND TRAFFIC CHANNELIZATION DEVICES PER THE MUTCD.

NOTE:
ERIAL RD (CR-706)
URBAN MAJOR COLLECTOR
25 MPH

PREPARED BY:
PIKE TELECOM
21 Oxford Rd
Mansfield, MA 02048
www.piketecom.com
1-508-337-7600

PREPARED FOR:
verizon

TITLE:
TRAFFIC MANAGEMENT PLAN - PHASE II
ERIAL RD (CR-706)
SICKLERVILLE, NJ

SURVEYED BY: PIKE TELECOM PRINT NO: 2 OF 6
DRAWN BY: JB SCALE: 1" = 30"
DATE: 04/24/24 EWO: 4POGK9U WPI 2596187

04/24/2024 - IN:G:\DIV\PERSON\BAU\TMP\2024\MA-TMP\WPI\4POGK9U WPI 2596187 - ERIAL RD (CR-706) CAMDEN COUNTY - TMP.dwg

PHASE III

TRAFFIC LEGEND	
	WORK ZONE
	PROPOSED TRENCH
	CHANNELIZING DEVICE (CONE)
	SIGN
	FLAGGER
	SINGLE PARKING METER
	DOUBLE PARKING METER
	VARIABLE MESSAGE BOARD
	ARROW BOARD
	TYPE 3 BARRICADE
	HIGH LEVEL WARNING DEVICE
	CONSTRUCTION TRUCK
	TRUCK MOUNTED ATTENUATOR
	TRAFFIC FLOW
	TRAFFIC FLOW
	2 WAY TRAFFIC
	BARRIER
	UTILITY POLE
	UTILITY MANHOLE

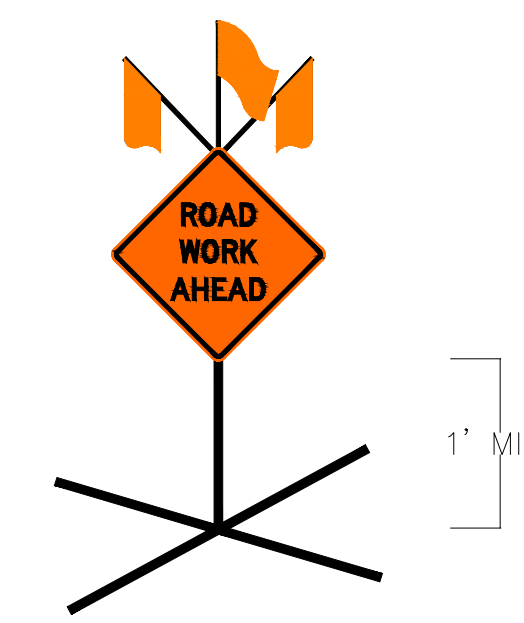
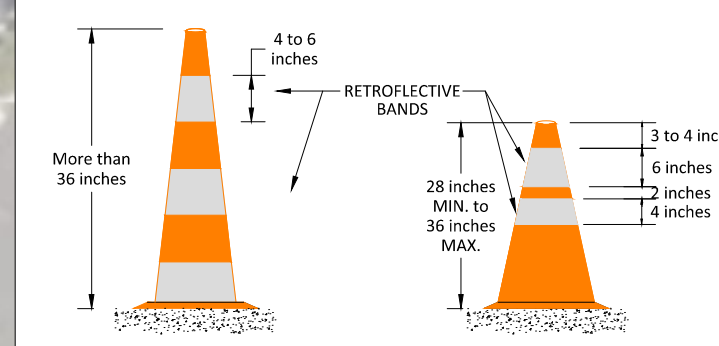
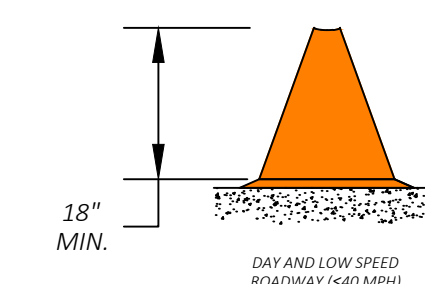

FREE STANDING SELF SUPPORT SIGN (TYPICAL) (NOT TO SCALE)

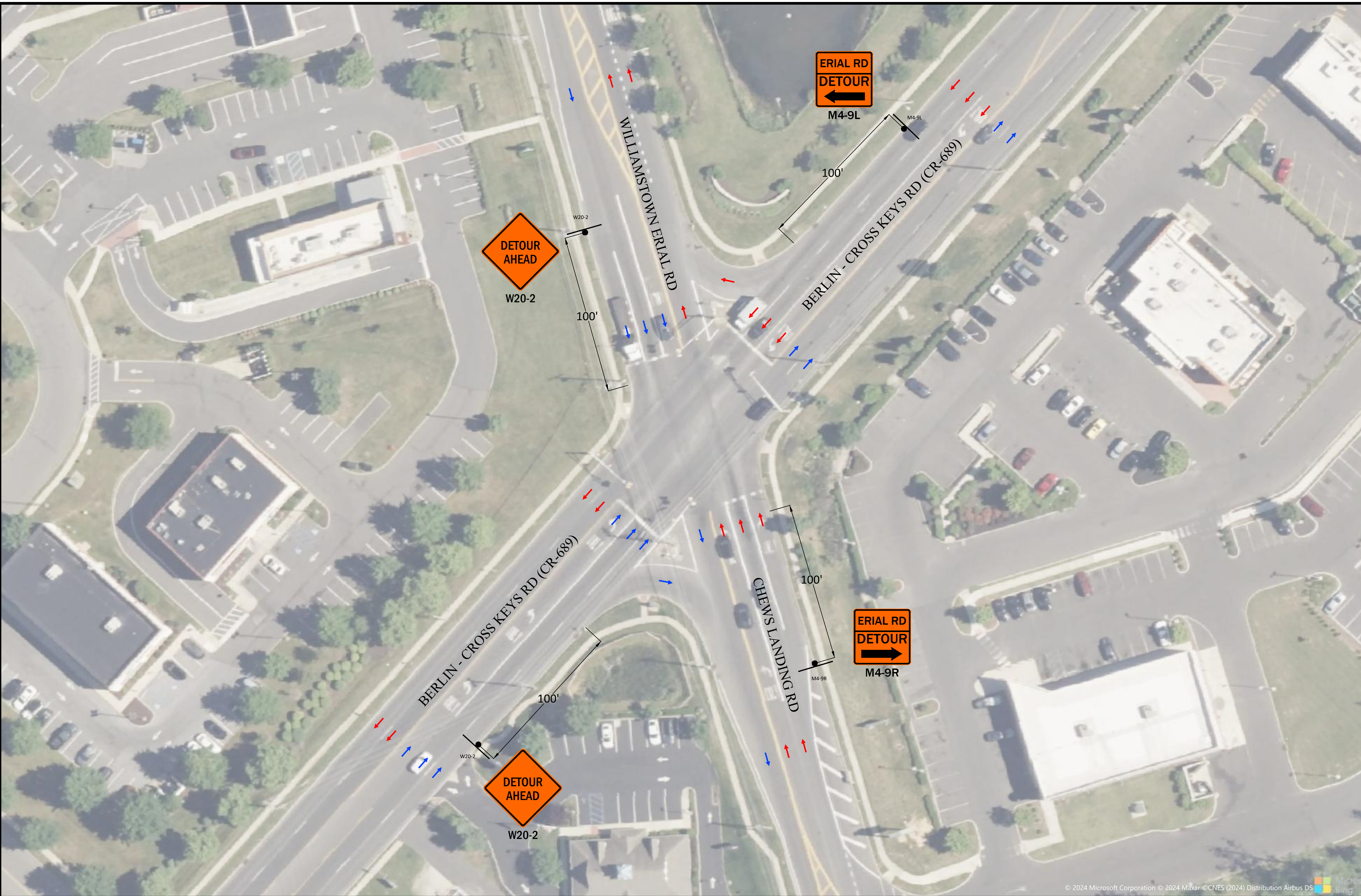

© 2024 Microsoft Corporation © 2024 Maxar © CNES (2024) Distribution Airbus DS

REV #	DESCRIPTION	DATE

NOTE:
EXISTING UTILITIES SHOWN ARE APPROXIMATE AND NOT WARRANTED TO BE CORRECT. THE CONTRACTOR SHALL VERIFY THE LOCATION OF ALL PUBLIC AND PRIVATE UTILITIES PRIOR TO BEGINNING ANY EXCAVATION.

ONE CALL
KNOW WHAT'S BELOW
CALL BEFORE YOU DIG
IT'S FREE AND IT'S THE LAW
CALL 811 OR 1-800-272-1000

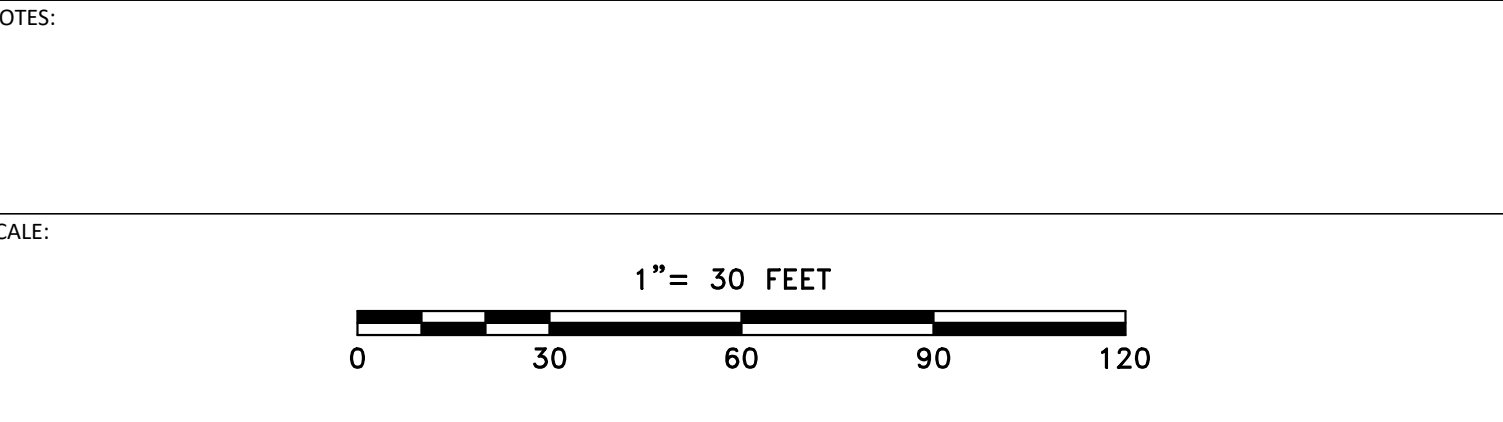

NOTE:
CONTRACTOR TO PLACE SIGNS AND TRAFFIC CHANNELIZATION DEVICES PER THE MUTCD.

NOTE:
ERIAL RD (CR-706)
URBAN MAJOR COLLECTOR
25 MPH

PREPARED BY:

PIKE TELECOM
21 Oxford Rd
Mansfield, MA 02048
www.piketelcom.com
1-508-337-7600

PREPARED FOR:

verizon

TITLE:	
TRAFFIC MANAGEMENT PLAN - PHASE III	
ERIAL RD (CR-706) SICKLERVILLE, NJ	
SURVEYED BY: PIKE TELECOM	PRINT NO: 3 OF 6
DRAWN BY: JB	SCALE: 1" = 30'
DATE: 04/24/24	EWO: 4POGK9U WPI 2596187

04/24/2024 - IN:G:\DIV\PERIZON\BAU\TMP\2024\MA-TMP\WPI\4POGK9U\WPI_2596187 - ERIAL RD (CR-706) CAMDEN COUNTY - TMP.dwg

PHASE IV

TRAFFIC LEGEND	
	WORK ZONE
	PROPOSED TRENCH
	CHANNELIZING DEVICE (CONE)
	SIGN
	FLAGGER
	SINGLE PARKING METER
	DOUBLE PARKING METER
	VARIABLE MESSAGE BOARD
	ARROW BOARD
	TYPE 3 BARRICADE
	HIGH LEVEL WARNING DEVICE
	CONSTRUCTION TRUCK
	TRUCK MOUNTED ATTENUATOR
	TRAFFIC FLOW
	TRAFFIC FLOW
	2 WAY TRAFFIC
	BARRIER
	UTILITY POLE
	UTILITY MANHOLE

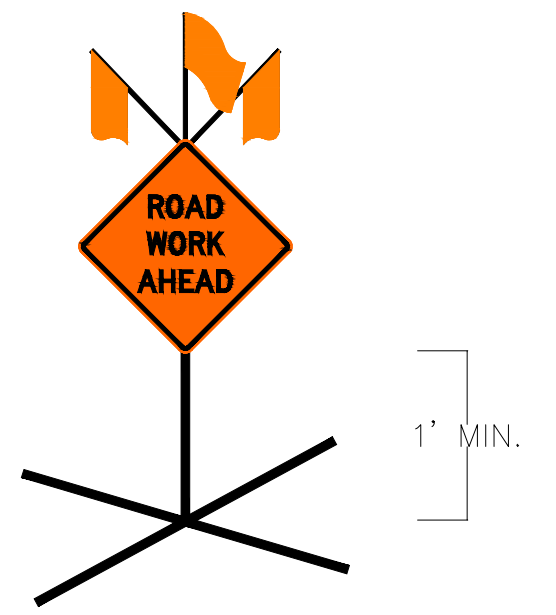
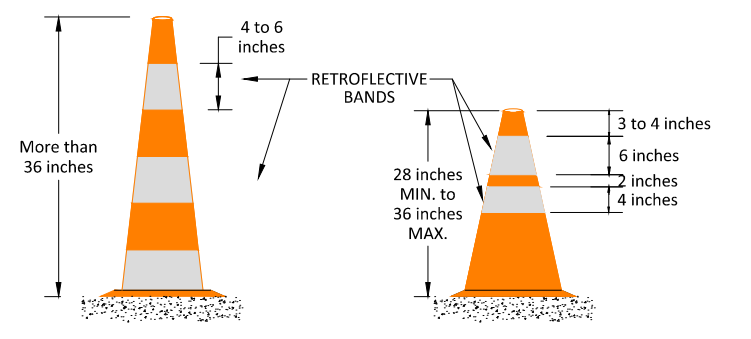
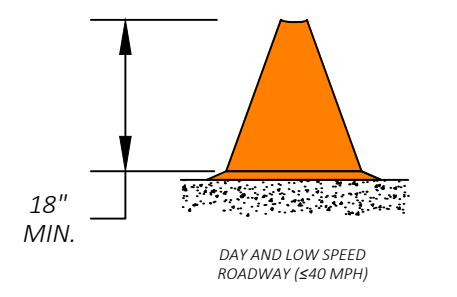

FREE STANDING SELF SUPPORT SIGN (TYPICAL) (NOT TO SCALE)

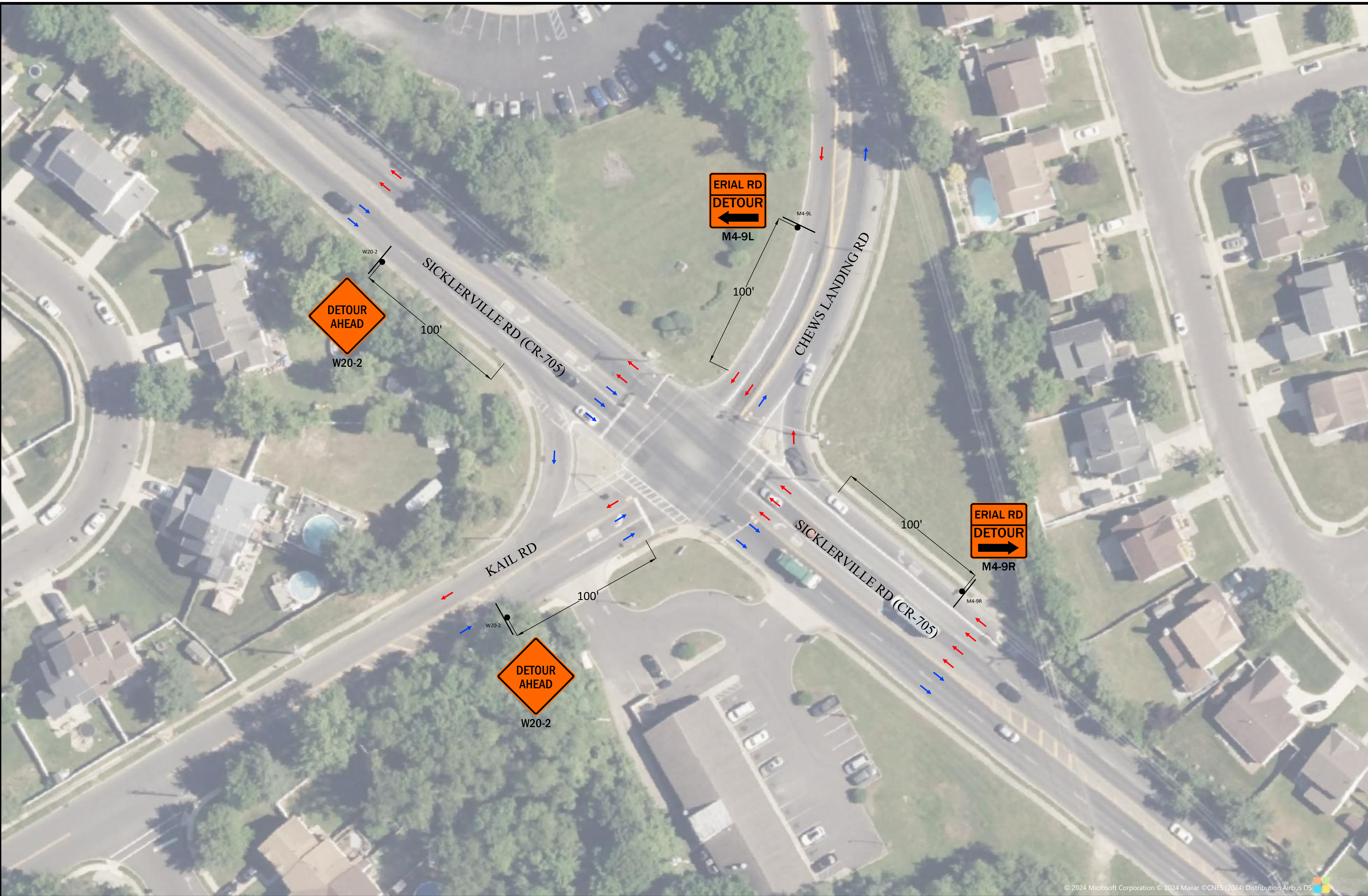

© 2024 Microsoft Corporation © 2024 Maxar © CNES (2024) Distribution Airbus DS

REV #	DESCRIPTION	DATE

NOTE:
EXISTING UTILITIES SHOWN ARE APPROXIMATE AND NOT WARRANTED TO BE CORRECT. THE CONTRACTOR SHALL VERIFY THE LOCATION OF ALL PUBLIC AND PRIVATE UTILITIES PRIOR TO BEGINNING ANY EXCAVATION.

ONE CALL
KNOW WHAT'S BELOW
CALL BEFORE YOU DIG
IT'S FREE AND IT'S THE LAW
CALL 811 OR 1-800-272-1000

NOTES:

SCALE: 1" = 30 FEET

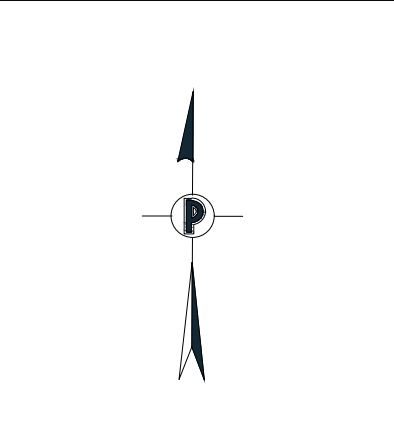

NOTE:
CONTRACTOR TO PLACE SIGNS AND TRAFFIC CHANNELIZATION DEVICES PER THE MUTCD.

NOTE:
ETRIAL RD (CR-706)
URBAN MAJOR COLLECTOR
25 MPH

PREPARED BY:
PIKE TELECOM
21 Oxford Rd
Mansfield, MA 02048
www.piketecom.com
1-508-337-7600

PREPARED FOR:
verizon

TITLE:	
TRAFFIC MANAGEMENT PLAN - PHASE IV ERIAL RD (CR-706) SICKLERVILLE, NJ	
SURVEYED BY: PIKE TELECOM	PRINT NO: 4 OF 6
DRAWN BY: JB	SCALE: 1" = 30'
DATE: 04/24/24	EWO: 4POGK9U WPI 2596187

04/24/2024 - IN:G:\DIV\PERFORM\SALE\TMP\2024\44-TMP\WPI\4POGK9U WPI 2596187 - ETRIAL RD (CR-706) CAMDEN COUNTY - TMP.dwg

PHASE V

TRAFFIC LEGEND	
	WORK ZONE
	PROPOSED TRENCH
	CHANNELIZING DEVICE (CONE)
	SIGN
	FLAGGER
	SINGLE PARKING METER
	DOUBLE PARKING METER
	VARIABLE MESSAGE BOARD
	ARROW BOARD
	TYPE 3 BARRICADE
	HIGH LEVEL WARNING DEVICE
	CONSTRUCTION TRUCK
	TRUCK MOUNTED ATTENUATOR
	TRAFFIC FLOW
	TRAFFIC FLOW
	2 WAY TRAFFIC
	BARRIER
	UTILITY POLE
	UTILITY MANHOLE

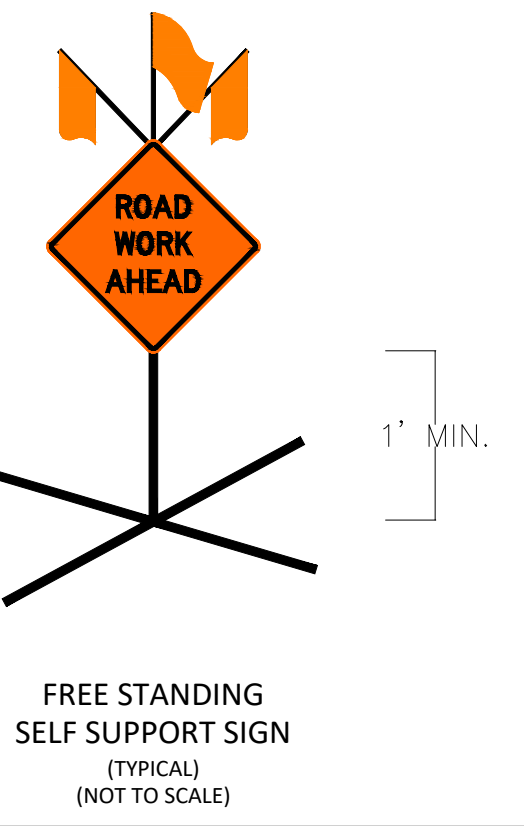
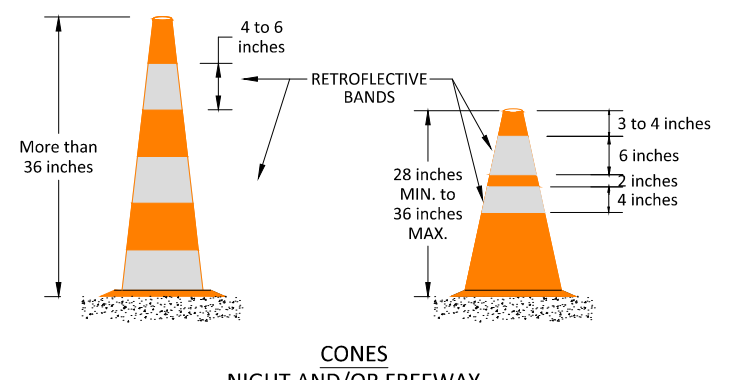
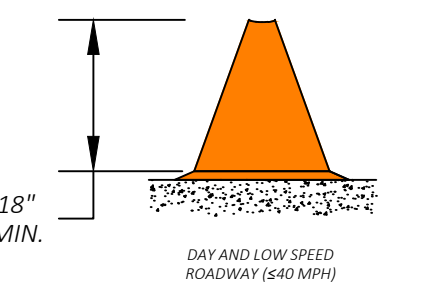

REV #	DESCRIPTION	DATE

NOTE:
EXISTING UTILITIES SHOWN ARE APPROXIMATE AND NOT WARRANTED TO BE CORRECT. THE CONTRACTOR SHALL VERIFY THE LOCATION OF ALL PUBLIC AND PRIVATE UTILITIES PRIOR TO BEGINNING ANY EXCAVATION.

KNOW WHAT'S BELOW CALL BEFORE YOU DIG IT'S FREE AND IT'S THE LAW
CALL 811 OR 1-800-272-1000

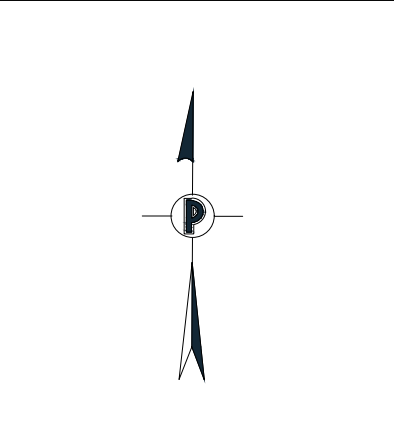
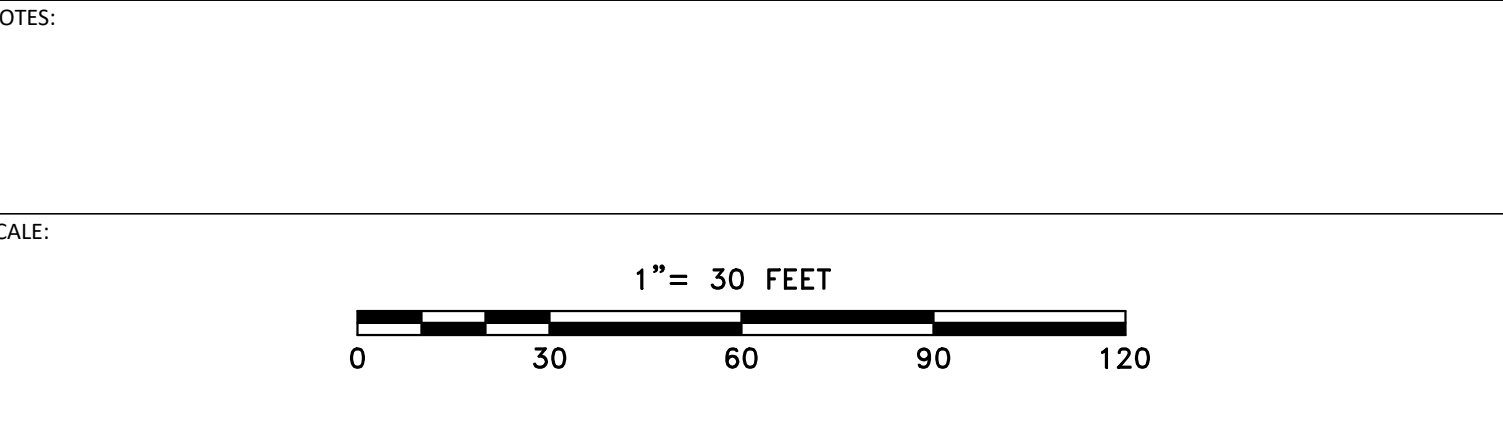

NOTE:
CONTRACTOR TO PLACE SIGNS AND TRAFFIC CHANNELIZATION DEVICES PER THE MUTCD.

NOTE:
ERIAL RD (CR-706)
URBAN MAJOR COLLECTOR
25 MPH

PREPARED BY:
PIKE TELECOM
21 Oxford Rd
Mansfield, MA 02048
www.piketecom.com
1-508-337-7600

PREPARED FOR:
verizon

TITLE:	
TRAFFIC MANAGEMENT PLAN - PHASE V ERIAL RD (CR-706) SICKLERVILLE, NJ	
SURVEYED BY: PIKE TELECOM	PRINT NO: 5 OF 6
DRAWN BY: JB	SCALE: 1" = 30'
DATE: 04/24/24	EWO: 4POGK9U WPI 2596187

04/24/2024 - IN:GDDIV/VERIZON/BAU/TMP/2024/04 - TMP/BAU/VERIZON/WPI/2596187 - ERIAL RD (CR-706) CAMDEN COUNTY - TMP/BAU - AUTOCAD/VERIZON/WPI/2596187 - ERIAL RD (CR-706) CAMDEN COUNTY - TMP/BAU - AUTOCAD/VERIZON/WPI/2596187 - ERIAL RD (CR-706) CAMDEN COUNTY - TMP/BAU

PHASE VI

TRAFFIC LEGEND	
	WORK ZONE
	PROPOSED TRENCH
	CHANNELIZING DEVICE (CONE)
	SIGN
	FLAGGER
	SINGLE PARKING METER
	DOUBLE PARKING METER
	VARIABLE MESSAGE BOARD
	ARROW BOARD
	TYPE 3 BARRICADE
	HIGH LEVEL WARNING DEVICE
	CONSTRUCTION TRUCK
	TRUCK MOUNTED ATTENUATOR
	TRAFFIC FLOW
	TRAFFIC FLOW
	2 WAY TRAFFIC
	BARRIER
	UTILITY POLE
	UTILITY MANHOLE

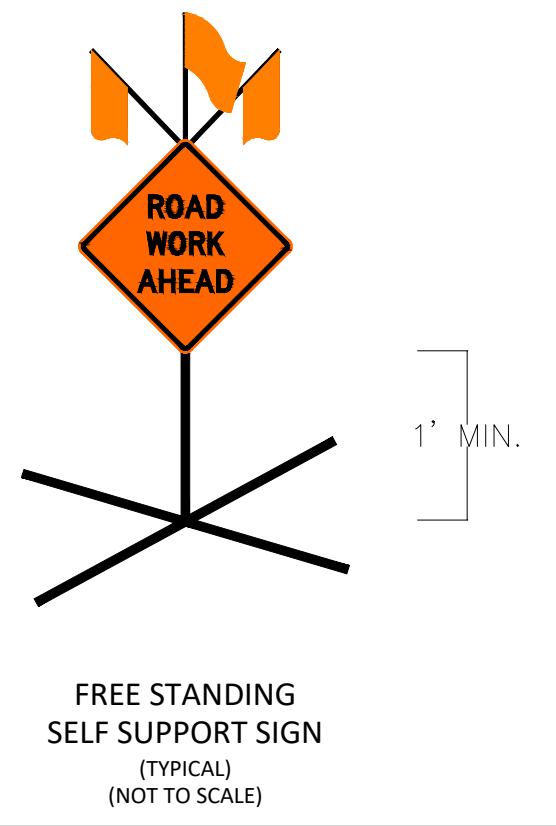
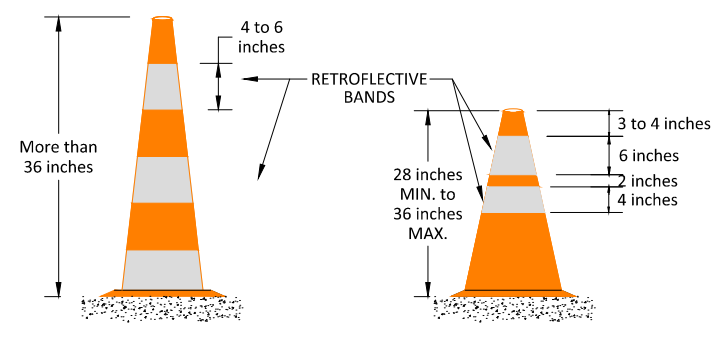
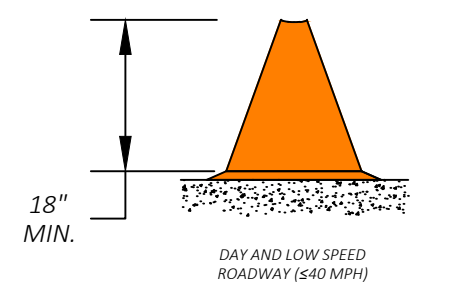

© 2024 Microsoft Corporation © 2024 Maxar ©CNES (2024) Distribution Airbus DS

REV #	DESCRIPTION	DATE

NOTE:
EXISTING UTILITIES SHOWN ARE APPROXIMATE AND NOT WARRANTED TO BE CORRECT. THE CONTRACTOR SHALL VERIFY THE LOCATION OF ALL PUBLIC AND PRIVATE UTILITIES PRIOR TO BEGINNING ANY EXCAVATION.

ONE CALL
KNOW WHAT'S BELOW
CALL BEFORE YOU DIG
IT'S FREE AND IT'S THE LAW
CALL 811 OR 1-800-272-1000

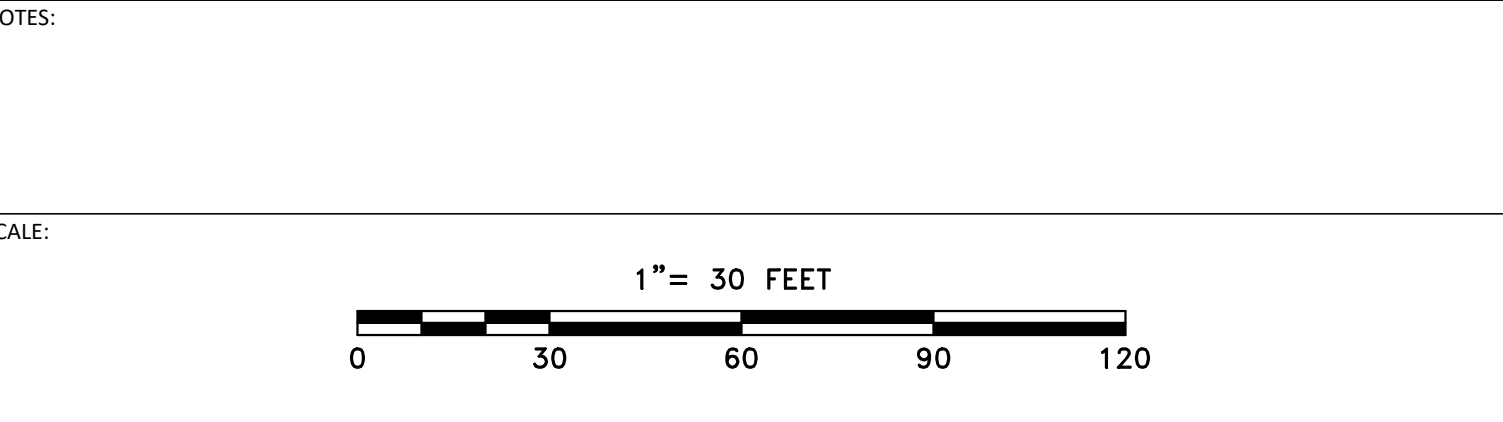

NOTE:
CONTRACTOR TO PLACE SIGNS AND TRAFFIC CHANNELIZATION DEVICES PER THE MUTCD.

NOTE:
ERIAL RD (CR-706)
URBAN MAJOR COLLECTOR
25 MPH

PREPARED BY:

PIKE TELECOM
21 Oxford Rd
Mansfield, MA 02048
www.piketelcom.com
1-508-337-7600

PREPARED FOR:

verizon

TITLE:	
TRAFFIC MANAGEMENT PLAN - PHASE VI ERIAL RD (CR-706) SICKLERVILLE, NJ	
SURVEYED BY: PIKE TELECOM	PRINT NO: 6 OF 6
DRAWN BY: JB	SCALE: 1" = 30'
DATE: 04/24/24	EWO: 4POG9U WPI 2596187

04/24/2024 - IN:G:\DIV\PERFORM\SALE\TMP\2024\MA-TMP\WMA\4P0G9U\WPI\2596187-ERIAL RD (CR-706) CAMDEN COUNTY - TMP.dwg